

DALI XC G3 CWM 30 DA2

Control module with 4 freely programmable inputs

Product description

DALI-2 input controller

- Compatible with all DALI-2 certified Application Controller
- 4 independent inputs enabling connection of floating contact, standard momentary-action switches
- Multiple DALI XCs possible on the DALI line
- Power supply via DALI line
- Connection wires according to the terminal colours with 25 cm length included
- 5-year guarantee



Standards, page 3

Wiring diagrams and installation examples, page 3

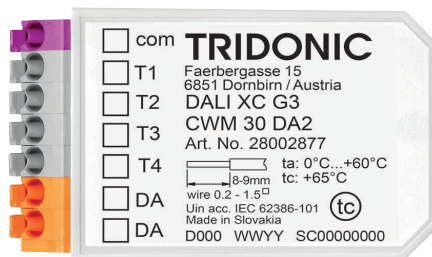



DALI XC G3 CWM 30 DA2

Control module with 4 freely programmable inputs

Technical data

Supply via	DALI
Supply voltage ^①	9.5 – 22.5 V
Current draw	max. 10 mA
Input	4 momentary-action switches or relais
Ambient temperature ta	0 ... +60 °C
tc	65 °C
Storage temperature	-25 ... +60 °C
Humidity	20 ... 90 % (non-condensing)
Turn on time	≤ 6 s
Type of protection	IP20
Mounting	Mounting box 60 x 61 mm (ø x D)
Casing material	Lexan 923
Casing colour	Light grey, similar to RAL 7035
Dimension L x W x H	47.7 x 28.2 x 14.6 mm

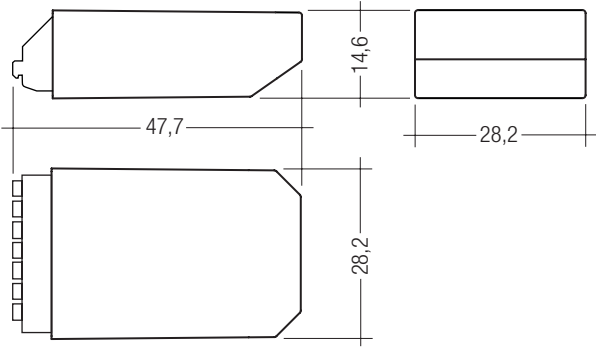

Ordering data

Type	Article number	Packaging, carton	Weight per pc.
DALI XCG3 CWM 30 DA2	28002877	60 pc(s).	0.087 kg

① Uin acc. IEC 62386-101.

1. Standards

EN 61347-1
EN 55015
EN 61347-2-11
EN 61547
EN 62386-101
EN 62386-103
EN 62386-301
EN 62386-332

1.1 DALI note



Device is developed according to DALI Standard EN 62386-101 Ed.2, also known as DALI-2.

To be able to use the device in such installation, an application controller is necessary.

List of approved application controller can be found on our WEB page „[Application_controllers_MSensor_G3.pdf](#)“

1.2 Glow wire test

according to EN 61347-2-11 passed for temperatures up to 850°C.

2. Installation

- Device can be inserted into the mounting box for the momentary switch.
- Device must not be connected to the mains. It is supplied directly via the DALI signal line.
- The momentary switches are connected directly to the device (potential free contacts) and must not be connected to the mains.
- DALI signals are not SELV. Therefore the same procedures should be applied as working with mains voltage.
- Only one momentary switch each device output.
- Multiple devices can be used on the same DALI network.

2.1 Connection diagrams

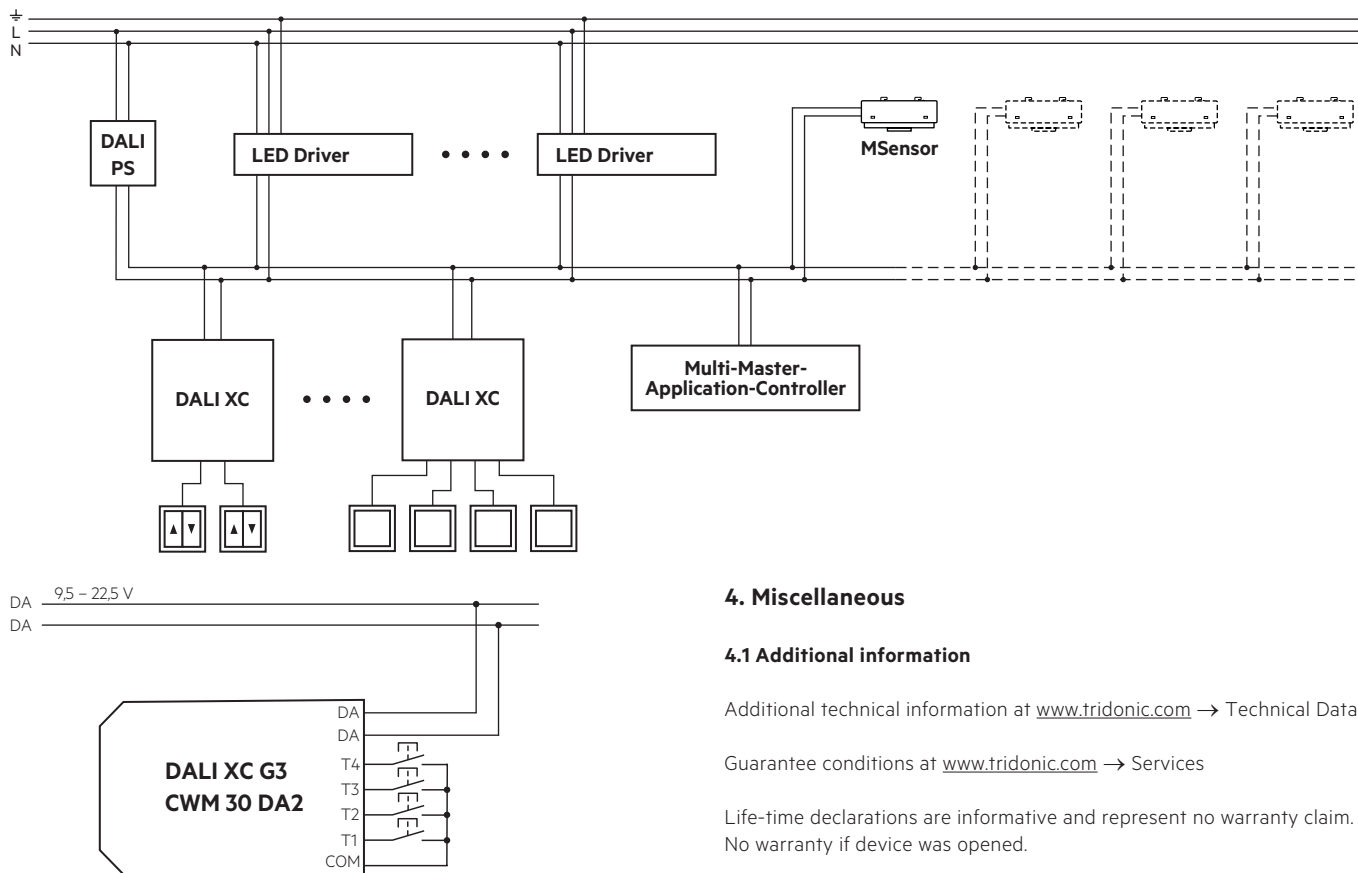

4. Miscellaneous

4.1 Additional information

Additional technical information at www.tridonic.com → Technical Data

Guarantee conditions at www.tridonic.com → Services

Life-time declarations are informative and represent no warranty claim.
No warranty if device was opened.

2.2 Wiring type and cross section

The wiring can be solid wire or stranded wire with end sleeve with a cross-section of 0.2 mm² to 1.5 mm².

Maximum cable length between momentary switch and device is 50 cm.

Connecting wires are supplied inside the package.

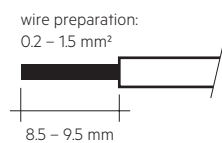

2.3 Terminals

Orange = DALI D1 and D2

Grey = Push button inputs T1 – T4

Purple = Push button common

2.4 Terminal and instance description

Device supports the full push button functionality according to IEC62386-301. The device has 4 button terminals.

These correspond to the 4 implemented DALI 301 instances:

Terminal	Instance nr.
T1	0
T2	1
T3	2
T4	3